

SI-1108

Serial ATA | SAS HDD-ROM

Quick Installation Guide



Content Description

Check this package is completed with these contents;
one SI-1108, 4 screws and 2 keys.



SI-1108

Front panel

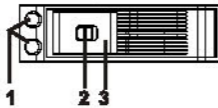

1. LED Display
Blue flash: HDD Access
Blue: Power on
2. Key lock
3. Spring lock

Rear panel

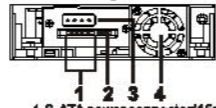

1. S-ATA power connector (15pin)
2. S-ATA data connector (7pin)
3. Power Cable
4. Cooler



1. SAS data connector (7pin)
2. S-ATA data connector (7pin)
3. Power Cable
4. Cooler

Key lock



Spring lock



Pull the hard drive spring lock to unload hard drive

Installing SI-1108

1. Remove the cover of an empty drive bay.

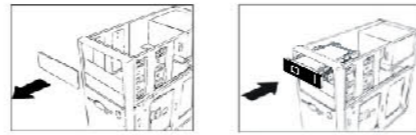

2. Smoothly insert SI-1108 into the bay and push it inward until the SI-1108 screw hole is aligned with the hole of the bay.

3. Secure SI-1108 with screws. Use two screws on each side will be good for SI-1108 safety function.

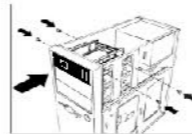

Connecting the SI-1108 cable

1. Connect the S-ATA power cable by plugging to the S-ATA power connector on the rear panel.
2. Connect the S-ATA data cable by plugging to the S-ATA data connector on the rear panel.

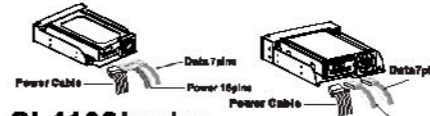

SI-1108 basics

Inserting Hard Drive into SI-1108

1. Pull the spring lock to open the front door.

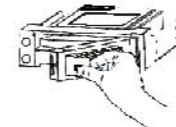

2. Place the hard drive into SI-1108 with the hard drive label (printed) side up and be sure the hard disk connectors side is inserted into SI-1108.

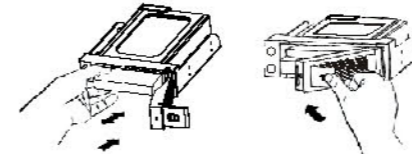

- ⚠ The front panel door will not be closed firmly if hard disk is being inserted in wrong direction SI-1108 will get damaged if closed by force.

3. Press the door to push hard drive into SI-1108 until the door lock.

Ejecting a hard drive from the SI-1108

1. Smoothly pull the spring lock to open the door. The key lock should be on the removable position. Otherwise, the locks would be damaged.

2. Carefully take the hard drive out from SI-1108

- ⚠ Hard disk may reach over 50°C when ejected from X-Rack. It will not burn the fingers, but please handle with care.

- ⚠ 1. Hard disk is a precise and accurate device, need to care highly. Please read the manual of hard disk for precaution.
- 2. Do not eject the hard disk while it is busy.
- 3. Please hold the hard disk by front edge, not to touch the PCB on it.
- 4. We will only provide repair service to our product malfunction problems, not be responsible for any software, hardware or data stored within that resulted in damaging to the product.