

# SI-3338SAS



## USER Manual

### Introduction

SI-3338SAS is a raid module based on the mainstream hard disk drive on the market today, It has removable trays for 3 SAS HDDs and can be applied for different Raid functions (SAS supported Motherboards or Controller card is required). Your data will be secured and reserved well by this device. On the other hand, the aluminum design & built-in cooling fan definitely helps for heat dissipating. The most fabulous thing is SATA-I, SATA-II hard drives compatible. SI-3338SAS offers an economical & convenient way for data backup.

### Features

- High performance starts at 3.0Gb/s (300MB/s) - Ideal for 3 Drive SAS Raid Configurations
- Fit for 2 x 5.25" Drive bays
- One Cooling fan for reliable thermal solution
- Dual port available
- Compatible with SATA-I or SATAII hard drives
- Clear & Multi-functional LED Indication
- Key lock design to avoid accidental removal
- LED for fan fail alarm

### Specification

Item	SPECIFICATIONS
Material	Metal
Dimension	200(L) x 148(W) x 85(H) mm
LED Indication	Blue for Power on Red for HDD access
Interface	3.5 SAS ,SATA-I & SATA hard disk drives
Cooling	80 x 80 x 10 mm
Color	Black
Weight	1000g
Safety Certificate	SAS supported Motherboard or Controller Card CE and FCC approval
System	2 Available Adjacent 5.25" bays
Requirement	1 Available 4-pin peripheral power connector from your power supply

### Hardware installation

#### 1 Front

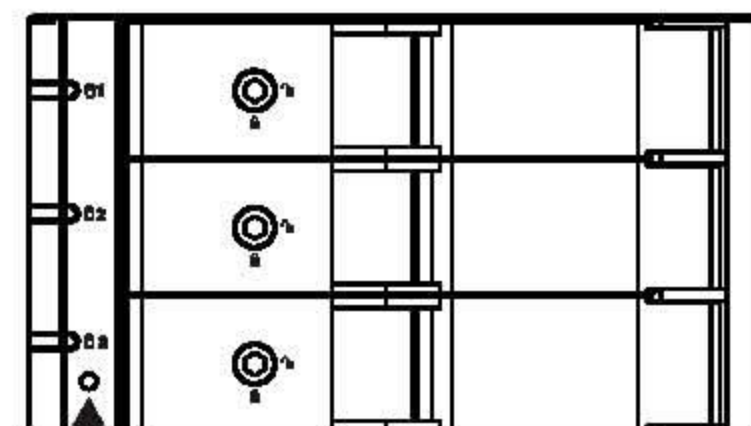

FAN LED INDICATOR : Light is green when fan is on, turns to red when off.

#### 2 BACK

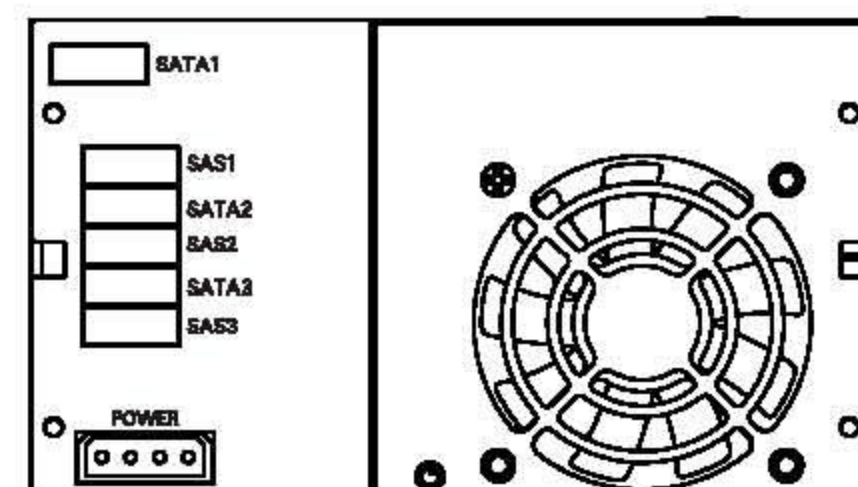

### The Hard Disk Installation:

The Hard Disk Installation: Sway from side to side the lock and pull the doorknob to insert 1, 2, 3 or 4 hard disk. Close the doorknob and the installation will be completed (The step will be represented in terms of following graphs)

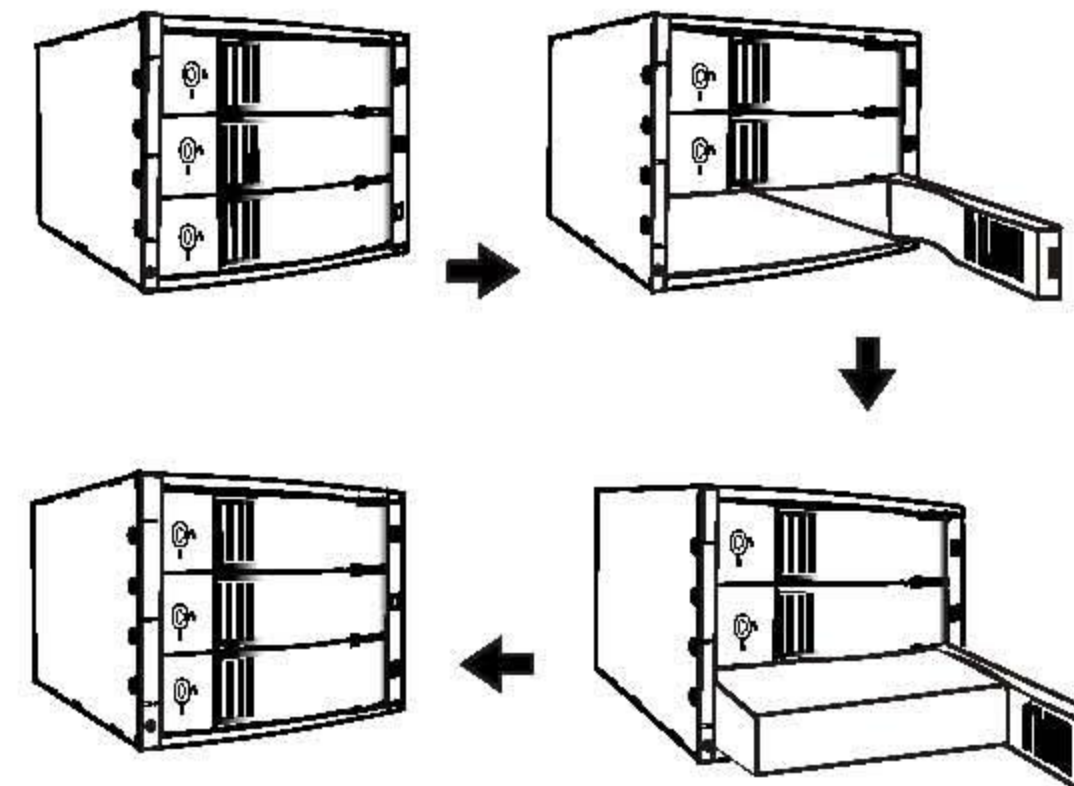

Note: Sway from side to side the lock at the instructed point, which you could open the doorknob to install/unload the hard disk. In Contrast, when you sway from side to side the lock at the instructed point, then you may not open it.

### FCC and CE Radiation Norm

#### FCC

This equipment has been tested and found to comply with limits for Class B digital device pursuant to Part 15 of Federal Communications Commission (FCC) rules.

#### CE

This equipment has been tested and found to comply with the limits of the European Council Directive on the approximation of the law of the member states relating to electromagnetic compatibility (89/336/EEC) according to EN 55022 Class B.

#### FCC and CE Compliance Statement

These limits are designed to provide reasonable protection against frequency interference in residential installation. This equipment generates, uses and can radiate radio frequency energy, and if not installed or used in accordance with the instructions, may cause harmful interference to radio communication. However, there is no guarantee that interference will not occur in television reception, which can be determined by turning the equipment off and on. The user is encouraged to try and correct the interference by one or more of the following measures:

- Reorient or relocate the receiving antenna
- Increase the separation between the equipment and the receiver
- Connect the equipment into an outlet on a circuit different from that to which the receiver is connected to

#### CAUTION!

The Federal Communications Commission warns the user that changes or modifications to the unit not expressly approved by the party responsible for compliance could void the user's authority to operate the equipment.